

GLOUCESTER COUNTY SURVEY MARK DATA SHEET

STATION NO.
081

HORIZONTAL DATA :		
VA. STATE PLANE COORD. - SOUTH ZONE (NAD 1983)		
UNITS	EASTING (X)	NORTHING (Y)
METERS	3680231.741	1132904.982
U.S. SURVEY FT.	12074226.970	3716872.428
LATITUDE (DMS)		37 30 48.24838
LONGITUDE (DMS)		76 27 40.09833
SCALE FACTOR		0.99994863
CONVERGENCE \sphericalangle (DMS)		1 14 14.77
VERTICAL DATA :		
REF. TO NATL. GEOD. VERT. DATUM (1988)		
UNITS	STATION ELEVATION	
METERS	9.56	
U.S. SURVEY FT.	31.36	

STATION DESCRIPTION :

DISTRICT : PETSORTH

A 3-1/4" ALUMINUM DISK MONUMENT SET APPROXIMATELY FLUSH WITH THE GROUND STAMPED STATION NO. 081. TO REACH: FROM THE INTERSECTION OF STATE ROUTE 602 AND STATE ROUTE 198 AT DUTTON, GO ABOUT 0.2 MILE EAST ON STATE ROUTE 198 TO INTERSECTION OF STATE ROUTE 198 AND STATE ROUTE 703; GO ABOUT 1.25 MILES NORTH ON STATE ROUTE 703 TO MONUMENT SITE ON THE EAST SIDE OF STATE ROUTE 703.

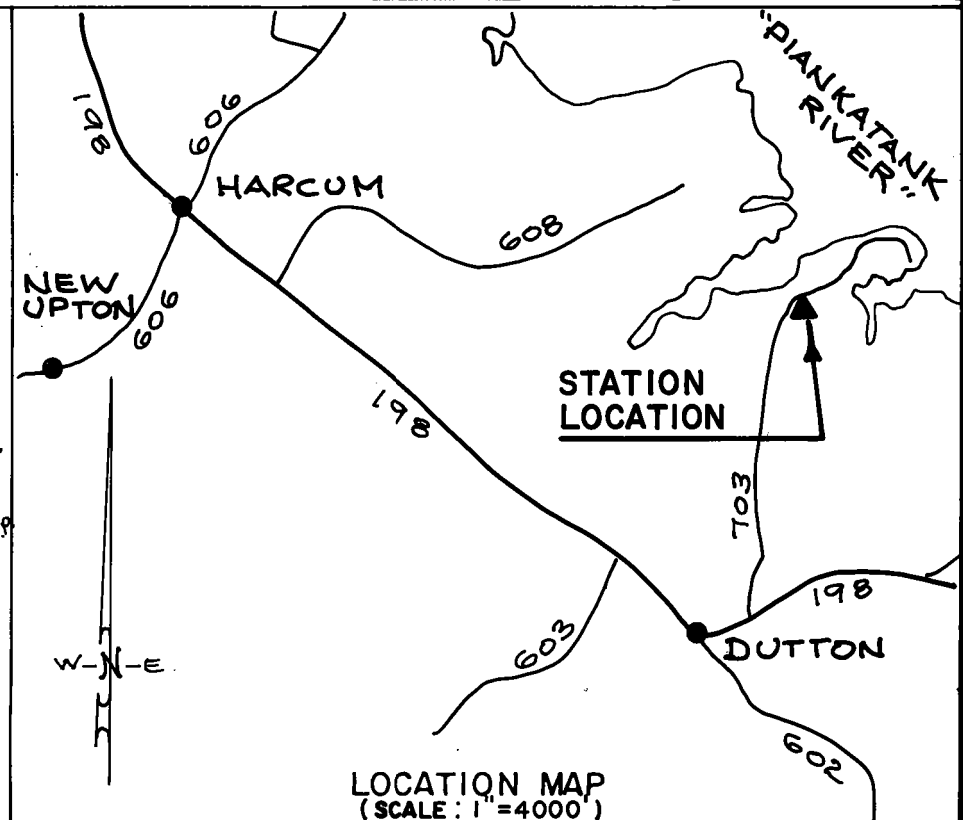
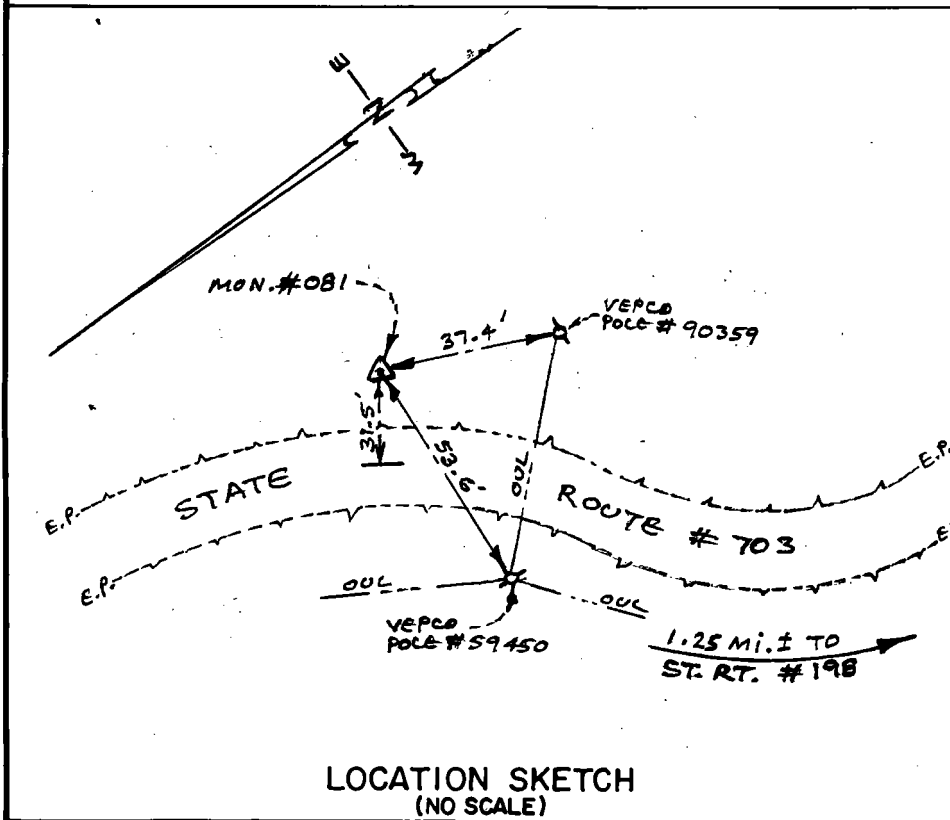

DATE: JANUARY, 1992

NOTE: USERS OF MONUMENTS LOCATED ON PRIVATE PROPERTY
MUST OBTAIN LAND OWNERS PERMISSION BEFORE ENTERING



DAWSON & PHILLIPS, P.C.
CERTIFIED LAND SURVEYORS
(804) 693-2993