

GLOUCESTER COUNTY SURVEY MARK DATA SHEET

STATION NO.
109

HORIZONTAL DATA : VA. STATE PLANE COORD. - SOUTH ZONE (NAD 1983)		
UNITS	EASTING (X)	NORTHING (Y)
METERS	3676720.523	1119315.903
U.S. SURVEY FT.	12062707.249	3672288.925
LATITUDE (DMS)		37° 23' 29.97735"
LONGITUDE (DMS)		76° 30' 14.74754"
SCALE FACTOR		0.99994549
CONVERGENCE \angle (DMS)		1 12 40.91
VERTICAL DATA : REF. TO NATL. GEOD. VERT. DATUM (1988)		
UNITS	STATION ELEVATION	
METERS	22.00	
U.S. SURVEY FT.	72.17	

STATION DESCRIPTION :

DISTRICT : WARE

A 3-1/4" ALUMINUM DISK MONUMENT SET APPROXIMATELY FLUSH WITH THE GROUND STAMPED STATION NO. 109. TO REACH: FROM THE INTERSECTION OF U. S. ROUTE 17 (BUSINESS) AND STATE ROUTE 629, GO ABOUT 1.4 MILES SOUTHEAST ON STATE ROUTE 629 TO INTERSECTION OF STATE 629 AND STATE ROUTE 626; MONUMENT IS IN THE SOUTHEAST QUADRANT OF THE INTERSECTION.

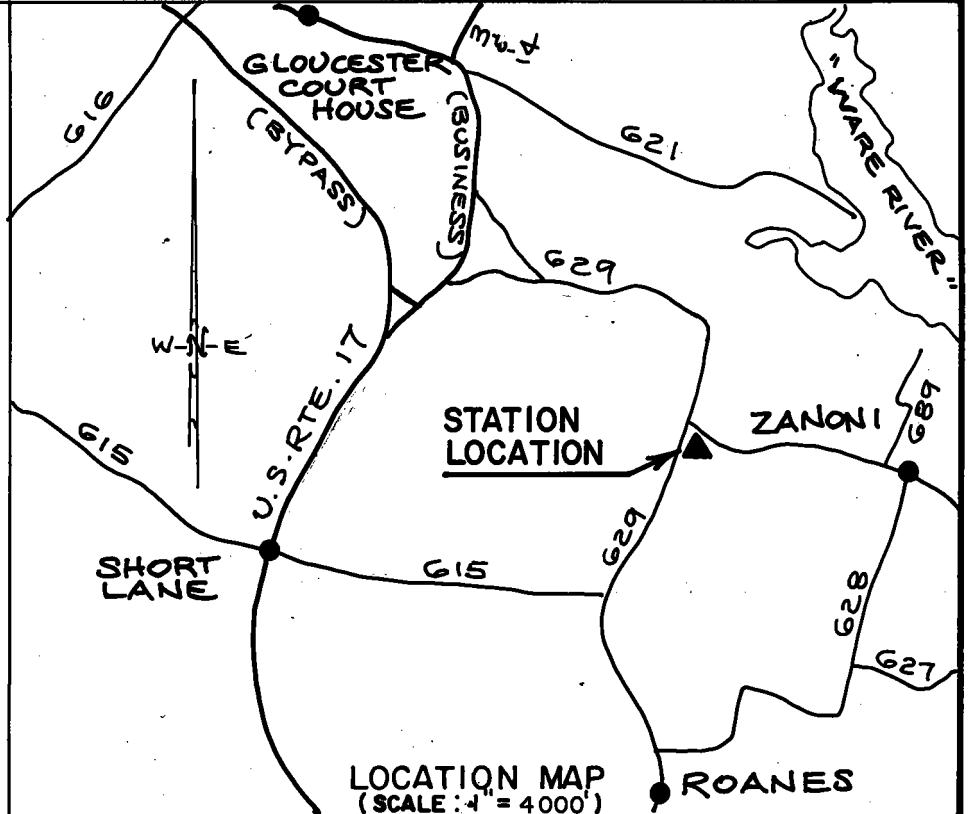
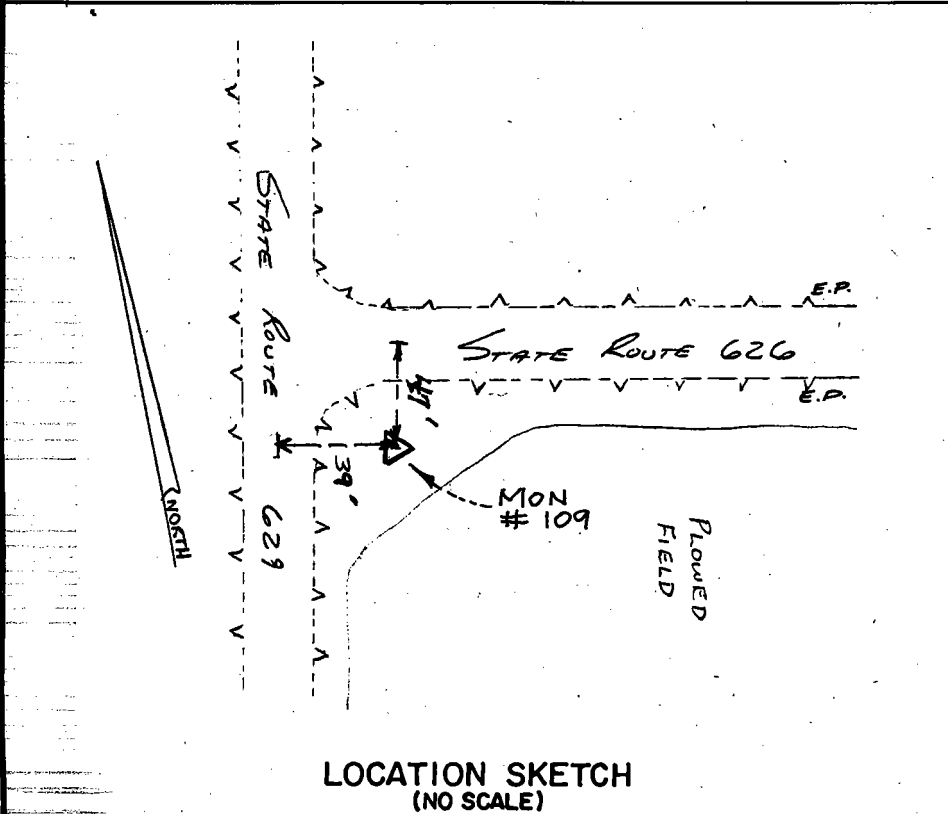

DATE: JANUARY, 1992

NOTE: USERS OF MONUMENTS LOCATED ON PRIVATE PROPERTY
MUST OBTAIN LAND OWNERS PERMISSION BEFORE ENTERING



DANSON & PHILLIPS, P.C.
CERTIFIED LAND SURVEYORS
(804) 693-2993